

Wheel installation angles- Alignment (00154)

Equipment and tools:

	Wheel aligner
---	---------------

Refer to the instructions – COMBI - Putting the vehicle on hoist (00410)

⚠ ATTENTION: Securely fix the vehicle on the wheel aligner platform to prevent its inadvertent movement during work.

⚠ ATTENTION: Before the procedure, carefully study the wheel aligner operation manual.

⚠ ATTENTION: In case of malfunctions of the steering, suspension, wheels and tires, it is prohibited to perform the procedure.

⚠ CAUTION: Before the procedure, check tire pressure.

⚠ CAUTION: For more information on the wheels alignment, refer to the “Steering - Specifications and Adjustment Data”.

⚠ CAUTION: The design of the steering and suspension allows only toe-in adjustment. Other parameters are for reference only.

⚠ CAUTION: Before the procedure, make sure the steering gear and the steering wheel are in middle position.

Checking:

Image	Operation description
1. Measure caster, camber, and toe angles.	

Alignment:

Image	Operation description
-------	-----------------------

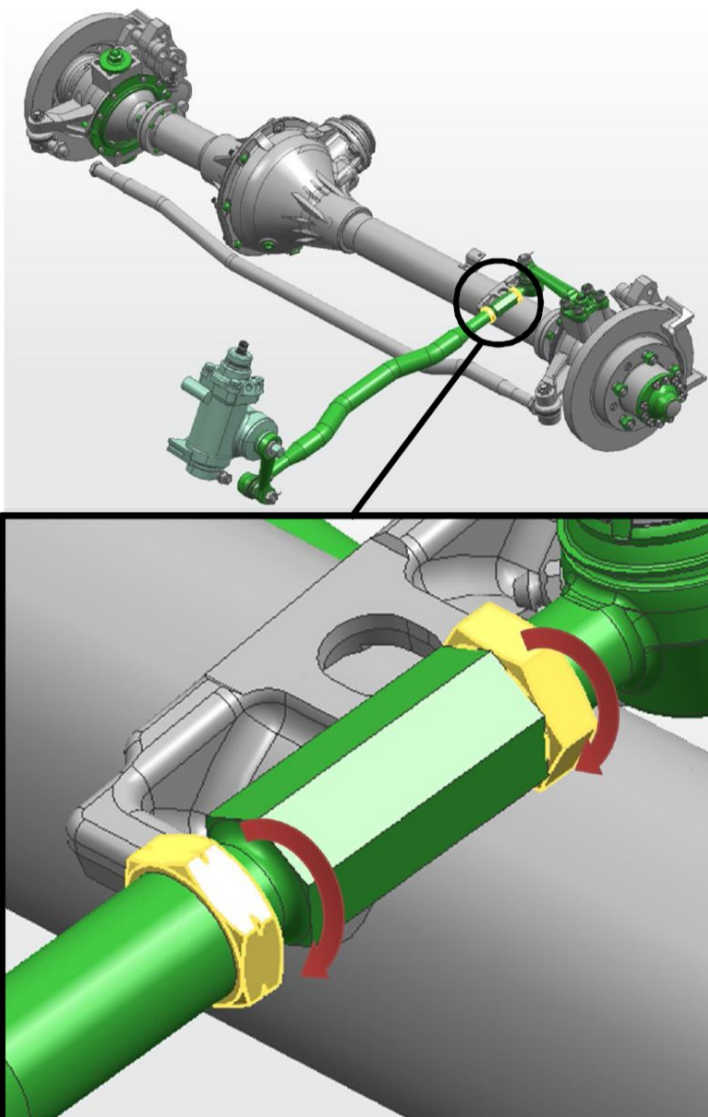

Pic. 1

1. Loosen the track rod lock nut.

S=24

S=27

Torque - 120 N·m

The sleeve and the nut have a left hand thread.

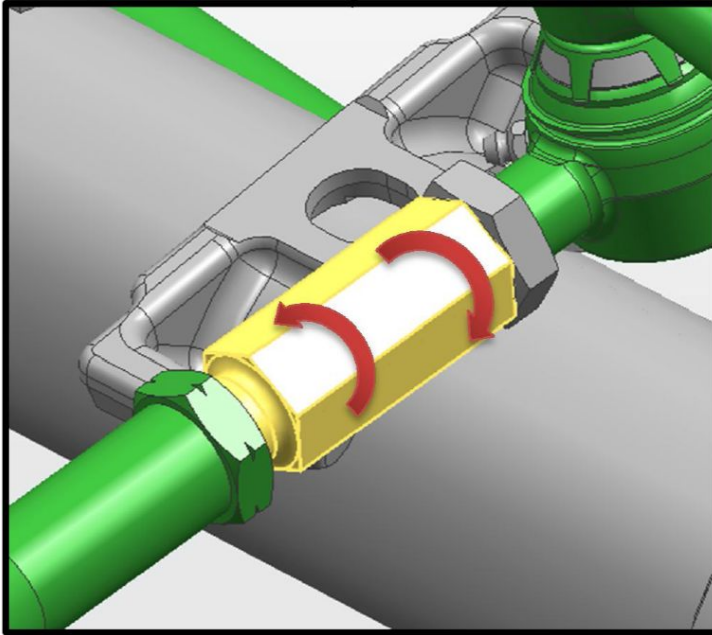
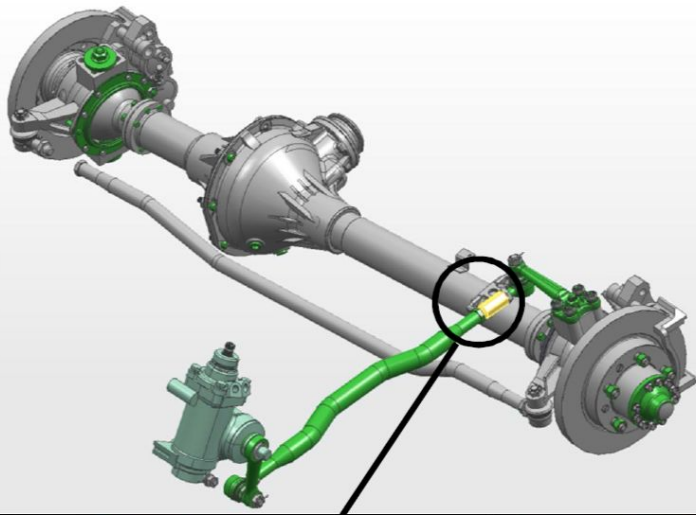

Pic. 2

2. Adjust the position of front left wheel by rotating the adjusting sleeve of the track rod.

S=24

The sleeve and the nut have a left hand thread.

3. Tighten the lock-nuts of the track rod.

S=24

S=27

Torque - 120 N·m

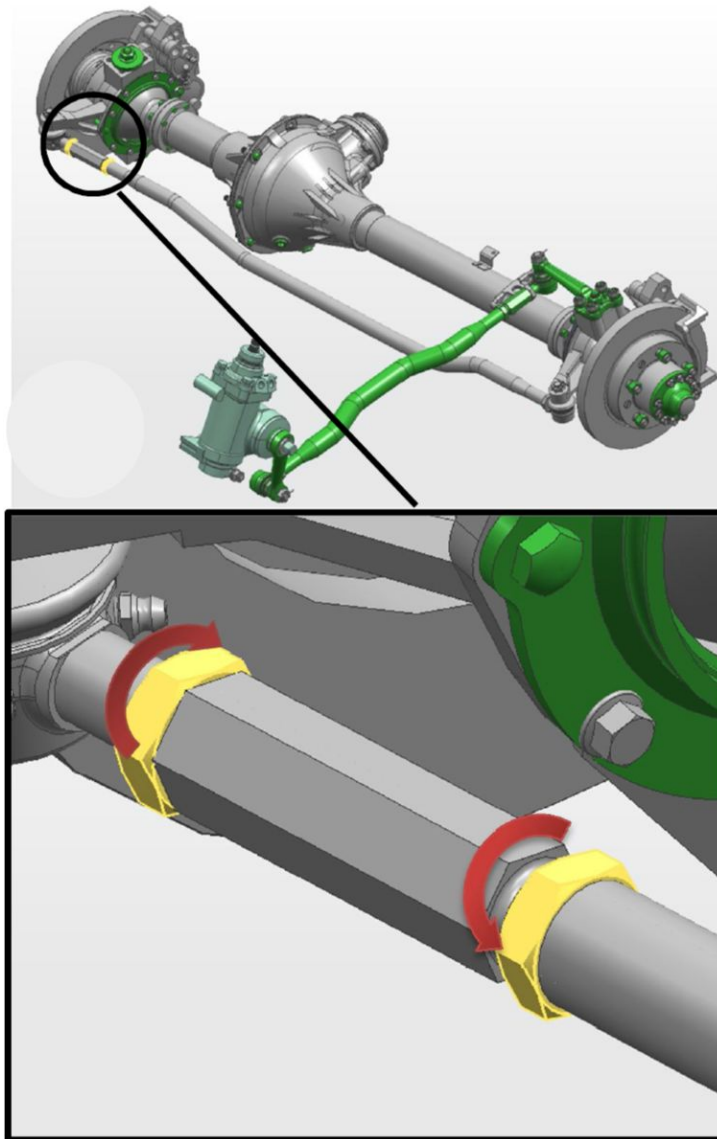

Pic. 3

4. Loosen the tie rod lock nuts.

S=24

S=27

Torque - 120 N·m

The sleeve and the nut have a left hand thread.

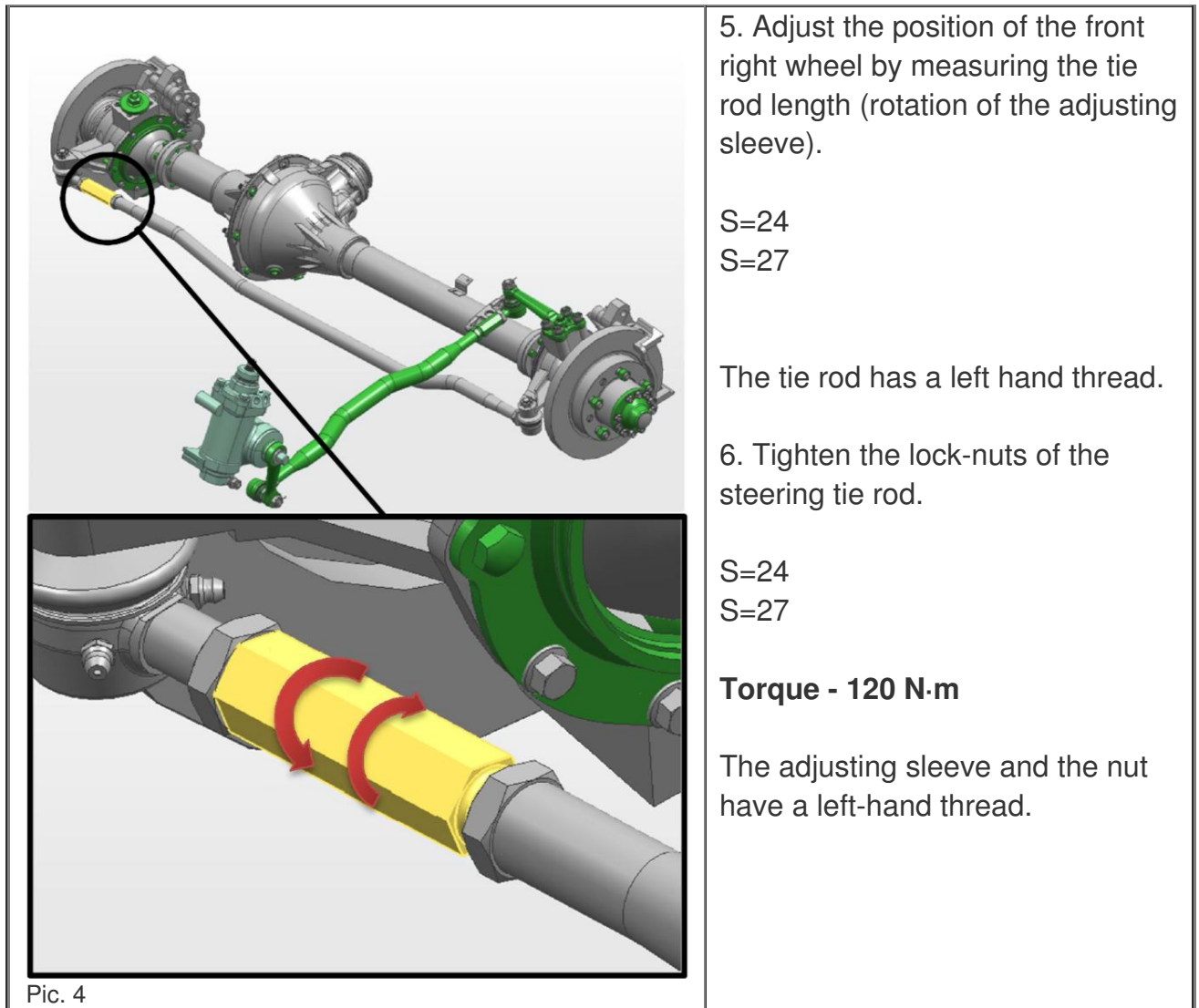

⚠ CAUTION: Check if the wheel alignment is correct. If necessary repeat the procedure.

⚠ CAUTION: After the procedure, print out the wheel alignment report.