



RIF

www.rif4x4.ru

4X4 EQUIPMENT FOR UAZ



**For UAZ Hunter, UAZ Bus,
UAZ Patriot**



ABOUT US



RIF is the oldest and most famous Russian brand of tuning accessories for 4x4 vehicles and for trailering. We started as the manufacturer of a reliable and high-quality body armor that is suitable for Russia's environment and customized for specific models of Russian and imported 4x4 vehicles.

Russia is offroad country with many remote hard-to-reach regions, it has very limited number of good roads, and UAZ vehicles - are actually major part of all 4x4 here. UAZ is Russian legend, the most popular and numerous in any corner of the country. Bull bars and rear bars for UAZ Hunter – were the first products **RIF** started with in 2003. Now we have almost everything for UAZ – beginning with reinforced front and rear bars, suspension and ending with lights and lockers. We manufacture LED lights, powerful 150A generators for UAZ, high-performance electric fans, reinforced suspension items, wheel hubs, kevlar ropes for winches, portable winch mount frames and towing and dynamic straps.

RIF manufacturing plant for the reinforced 4x4 equipment is the most advanced in the CIS because we use only the

newest and most advanced equipment, including automated welding lines from Japan and bending lines from Germany.

Our skilled workers, engineers and designers have been working together since the start of production in 2003, so they have more than a decade of professional experience. They know all the details related to the design of reinforced equipment, and they have an excellent understanding of the purpose of each item, as well as the requirements dictated by our customers and conditions of use.

All **RIF** products offer exceptional quality and can successfully compete with the best international brands – but there is no other brand, which produces something good for UAZ. **RIF** is always striving to do more, as we continuously extend the range of products and accessories and offer new products to satisfy even the most demanding 4x4 drivers. Annually **RIF** equips 4x4 vehicles for extreme offroad expeditions.

All **RIF** equipment is designed for heavy-duty service in all enviromental conditions and climatic zones - from South to North. it get thoroughly tested in real conditions of hard Russian offroad.



BULL BARS

RIF bull bars ensure perfect protection for the 4x4 - in case of contact or light collision with trees, stones, timbers, ruts or unlucky drivers, the risk of major damage to the vehicle body is significantly reduced, which is a very important advantage both during expeditions and in everyday driving.

RIF bull bar will also make a vehicle look more bright and attractive, thanks to its vibrant and elegant design. All **RIF** bars provide maximum reliability and resistance to high loads and strong impact; they have been designed for tough offroad conditions in various climatic zones.

ELEGANT APPEARANCE
HEAVY-DUTY DESIGN
TOP QUALITY MATERIALS

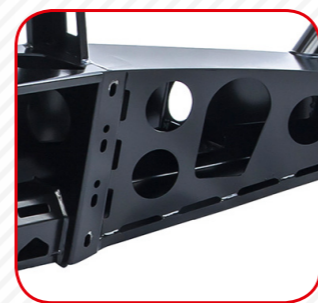

Reinforced internal stiffeners 3-4 mm steel



Reinforced towing eyes



Accurate welding and bends



Reinforced hi-lift jacking points

DURABLE DOUBLE POWDER COATING, PREVENTING CORROSION



By default all bull bars with supplementary lights are supplied with powerful and energy-saving **RIF** LED low beam lights!



BULL BARS FOR UAZ HUNTER AND UAZ BUS

RIF bull bars for Hunter and UAZ Bus have a very practical feature - they are available with or without internal stiffeners. Bars without stiffeners are less functional and durable, but have smaller weight and price!

- » With loops and internal stiffeners
- » Witout loops, with internal stiffeners
- » With loops, without internal stiffeners
- » Witout loops and internal stiffeners



Special model for UAZ Bus - bull bar with low loops

RIF BULL BARS FOR ALL UAZ VEHICLES ARE VERSATILE - THEY WILL SUIT BOTH STANDARD AND BODY-LIFTED VEHICLES. ALSO, THE BAR CAN BE SWAPPED FROM A LIFTED TO NON-LIFTED VEHICLE AND BACK AT ANY TIME

Important notice: bull bars for Hunter and UAZ Bus have no integrated mount frame for a winch, so it must be purchased separately. The mount frame is attached to the vehicle frame.

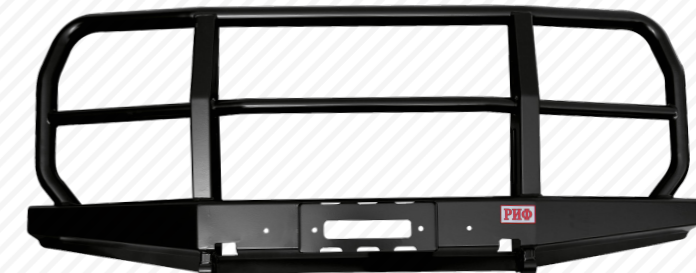
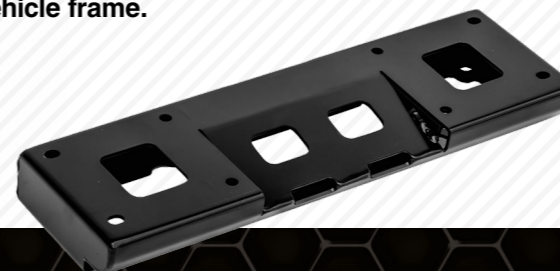



PERFECT PROTECTION NO MATTER OFF-ROAD OR IN CITY DRIVING

BULL BARS FOR UAZ PATRIOT, UAZ PATRIOT PICKUP

Important notice: bull bars for UAZ Patriot/Patriot Pickup and UAZ Simbir have an integrated mount frame for a winch. The optimal winch line pull is 4,100-4,300 kg, but the bull bar can also work with bigger winches, offering a line pull of up to 5,400 kg.

- >> Bull bar with loops and lights
- >> Bull bar without loops with lights
- >> Bull bar with lights and without loops
- >> Bull bar without loops and lights





ALL **RIF** REAR BARS FOR UAZ VEHICLES ARE MANUFACTURED FOR STANDARD AND BODY-LIFTED VEHICLES

REAR BARS **RIF** FOR UAZ HUNTER AND UAZ BUS

- » Rear bar with winch mount frame and wheel carrier
- » Tow bar with wheel carrier
- » Rear bar with winch mount frame without wheel carrier
- » Tow bar without wheel carrier

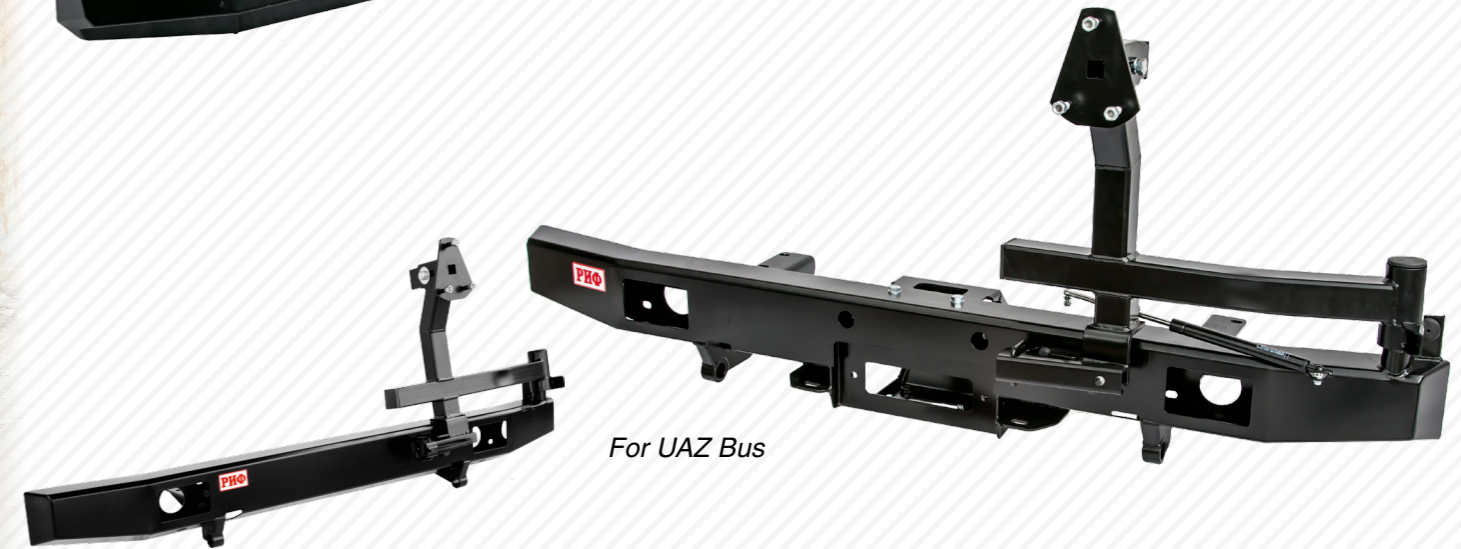
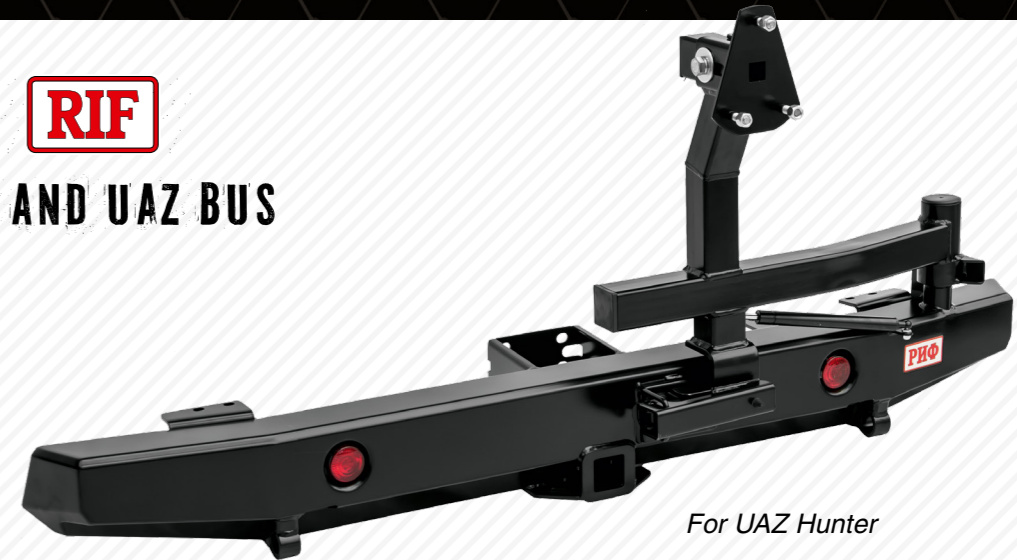

REAR BARS FOR UAZ PATRIOT

- » Rear bar with winch mount frame and wheel carrier
- » Tow bar with wheel carrier
- » Tow bar without wheel carrier
- » Rear bar with winch mount frame, without wheel carrier



REINFORCED HI-LIFT JACKING POINTS AND TOWING EYES

ALL RIF REAR BARS FOR UAZ VEHICLES ARE MANUFACTURED FOR STANDARD AND BODY-LIFTED VEHICLES

TOW BARS WITH LIGHTS FOR UAZ PATRIOT PICKUP



REAR BARS FOR UAZ PATRIOT 2015+

- » Rear bar with winch mount, wheel carrier and lights
- » Rear bar with winch mount, wheel carrier without lights
- » Rear bar with winch mount without wheel carrier and lights
- » Tow bar with lights and wheel carrier
- » Tow bar with lights without wheel carrier
- » Tow bar without lights and wheel carrier
- » Tow bar without lights and with wheel carrier



ANY REAR BAR FOR UAZ 4X4 CAN BE EQUIPPED WITH TWO WHEEL CARRIERS





WHEEL CARRIER FOR FACTORY REAR BUMPER FOR UAZ PATRIOT 2015+

The factory location of the spare wheel carrier on the trunk door of UAZ Patriot usually causes a lot of troubles. Even the weight of factory spare wheel makes the rear door warp after a while. And if the vehicle has bigger tires – warping and deformation of the door and door butts will start faster. There is usually no sense in attempts to reinforce the door butts, the only way – is to mount the special strong wheel carrier.

The main difference between **RIF** wheel carrier and other brands' carriers, is that **RIF** carrier is mounted to the

frame of the vehicle, not to the carbody, as others. With **RIF** wheel carrier there is no more danger, that vibration and shock loads with make heavy spare wheel destroy the metal of the carbody.

The reinforced **RIF** wheel carrier made of square pipe with a 6 mm wall. The durable design suitable for large spare wheels means that the carrier will be securely fixed to the frame. The wheel carrier has a lock that prevents it from opening in any off-road environment, while the gas strut will prevent an unintentional opening when going downhill.

FRONT AXLE CLUTCHES (HUBS) FOR UAZ 4X4

Wheel hubs are designed for de-coupling the wheels from half axles in order to ease the wheels' spinning while driving on good roads with the front axle disconnected. **RIF** hubs are made of steel, and no plastics or alloys are used. They are sealed. The hubs can withstand high loads. They are easy to install and use because the bolts connecting the clutch halves are not sunken. They are mounted on the external cover (in this case the bolts do not seize). They can be unscrewed using a regular spanner, not a Torx wrench, so the boltheads are not damaged.





STEERING ROD GUARD

This accessory has been designed to protect the steering rods from stones, logs, stubs, tree roots and other obstacles that may be encountered during off-road driving.

The guard is fixed to the frame of the vehicle, with no changes to the vehicle design.



**REINFORCED
DESIGN FOR
MAXIMUM
PROTECTION**

WINDOW PROTECTION

The window protection will facilitate forest driving by preventing damage to the vehicle windows from tree branches and bushes.

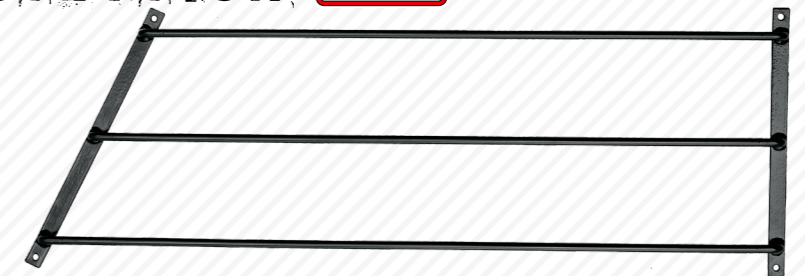



SIDE STEPS

RIF heavy duty side steps serve to protect the body of your UAZ both in the city and during off-road driving. If you bump into a log, stone or rut edge, the step will provide reliable protection. Steps can easily withstand being lifted by a hi-jack.

RIF steps help you get into high vehicles easily, while the practical step cover made of fluted aluminum will suit any type of sole.

RIF steps offer a very strong and durable design, having been engineered for tough conditions. The steps are secured to the frame of the vehicle using U-bolts.

Their stylish and vibrant appearance perfectly emphasizes the rugged look of your UAZ!

Manufactured for standard and body-lifted UAZ vehicles.

For UAZ Bus and UAZ Hunter



For UAZ Patriot



RIF SIDE STEPS ARE MADE OF ONE-PIECE STEEL PIPE WITH NO WELDING SEAMS

For UAZ Patriot 2015+



EXPEDITION ROOF RACKS

roof racks - offer a perfect safety margin and the best value in Russia's market. High quality of materials and manufacturing combine with amazing reliability even in most tough conditions. roof racks are easy to mount and have a beautiful elegant look.

The bottom of the rack is made of 25x25 mm square tube with a wall thickness of 2 mm and spaced 210 mm apart, and side - of the tubes 20 mm in diameter and 1.5 mm wall thickness.

The roof rack is mounted on the roof of the vehicle with the help of reinforced brackets.



SEPARABLE MODEL OF ROOF RACK

Also for UAZ Hunter have designed a separable model of roof rack for vehicles with big or standard hatch



ROOF RACK LADDER

The practical ladder provides comfortable access to the roof of your UAZ.

RESISTANT TO EVEN THE MOST AGGRESSIVE CHEMICALS, THE BLACK POWDER COATING PREVENTS THE CORROSION IN ANY ENVIRONMENT. WE OFFER A 3-YEAR WARRANTY, EXCLUDING MECHANICAL DAMAGE.

For UAZ Hunter with spare factory wheel have designed a special ladder



SNORKEL FOR UAZ BUS

The snorkel is a critical item for the UAZ Bus, since the filter is located under the passenger's seat and the air intake is too low. So when fording or crossing deep puddles (as the depth of each puddle cannot be measured, and they can be quite deep sometimes), the snorkel will provide protection against any risks, including water splashes from the wheels. The snorkel is also very important on dusty roads because it provides an intake of air from the top, where there is no dust or only a small amount. The snorkel is made of high-quality and durable specialized PE. It is very light and strong, so it can be used even in extreme temperatures.



ENGINE COOLING ELECTRIC FAN FOR THE UAZ HUNTER AND UAZ PATRIOT

The  electric fan offers higher performance compared to standard mechanical fans, ensuring a stable operating temperature of the engine in cold and hot weather. This accessory is especially suited for vehicles operated in harsh conditions with high loads and in the northern regions with extremely low temperatures. The fan can be mounted on UAZ Hunter and Patriot vehicles with petrol engines with no changes to the design. Installation on vehicles with diesel engines and on other UAZ models may require modifications to the fan casing.

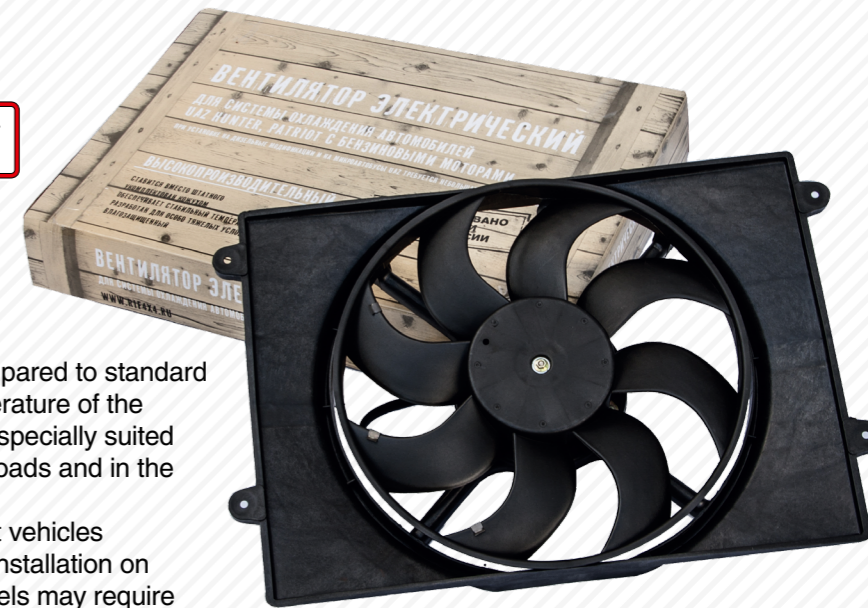

GENERATOR 150 A FOR UAZ HUNTER AND UAZ PATRIOT

(gasoline ZMZ409, no air conditioning) **Not for UAZ Patriot 2015+!**

The 150A  generator does not require any changes to the vehicle design for its installation. The high power generator is vital for the additional winch, enhanced lights, acoustic system, heaters, for supplementary heating of the vehicle, etc., since the standard generator may be too weak to cope with all the loads (e.g. in case of long operation of the electric winch or autonomic heaters or the simultaneous use of several high-power loads).



LED LIGHTING

RIF led lighting offers high beam and low beam lights, combined beam lights, searching lights and light bars. RIF lights are equipped with LED elements by the US manufacturer Cree, a recognized leader in the LED light market. Such LED elements demonstrate perfect light output and form a non-glare, visually pleasing beam of light. A

radiator for efficient cooling is in the rear part of the housing, which provides an extended service life. The unique reflector based on Hybrid technology makes it possible to focus the light beam produced by the LED. Each LED is connected independently, so the failure of any one LED element will not cause the light to malfunction.









THE LIGHTS ARE FULLY WATERPROOF AND DUSTPROOF, THEY HAVE BEEN DESIGNED FOR EXTREME DRIVING CONDITIONS TO ENSURE PROPER PROTECTION FROM VIBRATIONS, SHAKING OR IMPACTS.





PORTABLE WINCH ON FRAME WITH CHAIN FASTENINGS TO TOWING EYES WITH STEEL OR SYNTHETIC ROPE

The  portable winch is a ready-to-go device that comes on a  mount frame complete with cables and fairleads already attached. This factory-assembled product is ready for use. Lengthy cables and fastening chains are packaged into a robust handy capron bag.

The obvious benefits of the  portable winch are that it will always be in good working order (no soaking, no freezing, no contamination with chemicals on winter roads), it can be mounted on any side of the vehicle, i.e. in the front, back or on the side, and one winch can serve several vehicles.

The winch is mounted into a compact and versatile  mount frame with D-rings for towing eyes. Its main advantage is that it is very easy to use.

To start using the  portable winch, simply attach it to the towing eyes with the chains.

The  portable winch has an excellent safety margin and clever design — all the corners are smoothed for ease of use and handling, two convenient and easy-to-grasp hand grips make it possible for the winch to be handled by two people or even just one, and the soft rubber legs of the winch will be gentle to the trunk of your car.



 PORTABLE WINCHES OFFER
LINE PULL FROM 4500 LBS TO
9500 LBS



PORTABLE WINCH  ON FRAME WITH HITCH WITH STEEL OR SYNTHETIC ROPE

The winch is mounted on a reinforced frame with two handles, that allow you to work with the winch comfortably even alone.

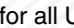
This type of portable winch is more practical and convenient than the model with fasteners on chains, but it requires the at least one (better two - front and rear) American standard two inch «square» hitches

on a vehicle for removable towing hitch. RIF offers few options how to get them -  rear bars have rear hitch of this type, also there is a special hitch adapter for  bull bars for UAZ Patriot/Patriot Pickup. And for all UAZ vehicles  have designed front and rear hitches for factory front and rear bumpers (see page 36).

SUSPENSION

Hi quality reinforced suspension improves the behavior of the vehicle in any terrain, enhance the approach and departure angle and raise the general performance of the suspension.

All lift kits by have been designed for heavy-duty service and for various types of road surfaces. leaf springs and shock absorbers, as well as RIF coil springs, not only compensate for the weight of optional equipment mounted on the vehicle (bumper bars, side steps, additional fuel tanks, winches, etc.), but they also increase the load capacity of the vehicle. The extended U-bolts and spring shackles are made of high-quality materials and offer a large margin of safety. bushes are made of PE. They

offer excellent elastic rigidity, wear resistance and thermal resistance to high and low temperatures.

The reinforced suspension by provides amazing performance on the most difficult roads, worn-down scraped roads, and asphalt roads with tight bends. Your vehicle will remain stable, steerable and comfortable.

The quality of all products matches the quality of the best international brands, in some cases even outperforming them, making us a leader in value in the Russian market.



EXCELLENT PERFORMANCE ON ANY SURFACE
HIGH QUALITY AND HUGE SAFETY MARGIN

LEAF-SPRINGS FOR UAZ HUNTER AND UAZ PATRIOT



Leaf-springs for UAZ Hunter and UAZ Patriot are offered in three types: B (0-150 kg), C (150-300 kg), D (300 kg, constant load). The stiffness level of the grade B and C leaf springs can be progressively adjusted. The low leaves, intended for high loads, kick in only if the vehicle is heavily loaded, which provides an amazingly comfortable ride when driving an unloaded car. D leaf springs always provide

maximum load capacity and suit better for All types of leaf springs include a full-length leaf with enhanced ends under the main spring leaf. This will enable you to get to a repair shop if the master leaf is cracked or broken.

For UAZ Bus offers front and rear leaf springs 0-300 kg (only for few-leaf spring vehicles!).

CASTOR KIT



Suspension arm bush kits with an offset axial position are used to compensate changes of longitudinal angular displacement from the vertical axis of a vehicle (caster angle), which is one of the most important properties affecting the handling of a car. The caster angle changes after installation of enhanced springs. Mounting a caster kit makes it possible to return the caster angle to its default value.

COIL SPACERS



Coil spacers are used to lift a vehicle without changing factory springs or to compensate settling of factory springs as well as eliminate possible differences in spring height (to level the vehicle). Spacers have the shape of a spring seat ensuring setting accuracy of springs.

Spacers are made of PE which is more resilient than metal or caprolon.



PNEUMATIC SUSPENSION

Air suspension allows to increase the load capacity without changing the standard factory springs.

It provides smooth soft riding un unloaded vehicle, and at the same time - to transport the heavy goods or to compensate the weight of the installed additional equipment.

STEERING DAMPER



Mounting bracket is included

**REINFORCED CHROME PLATED ROD.
LARGE OIL RESERVOIR.
HIGH COMPRESSION AND STRETCH
PROPERTIES AS COMPARED WITH A
FACTORY DAMPER.
DRAIN HOLES IN THE UPPER DUST BOOT
THAT LET THE MUD ESCAPE AND PREVENT
IT FROM COLLECTING IN THE HOUSING
AND WEDGING THE DAMPER**

BALL AND PINTLE HOOK

pintle hooks are specially designed for heavy-duty service and tough conditions, they are equipped with reinforced lock pin to prevent self-opening. This is an important feature for towing a trailer with coupling rings or for towing other vehicles using a rope, or for offroad driving with trailer. Resistant to even the most aggressive chemicals, the black powder coating prevents corrosion in any environment. Receiver mount pintle hook is made of a single-piece square steel bar. It can be fixed to a 2" (5 cm) hitch receiver and locked with a standard pin.



2" – 50 mm

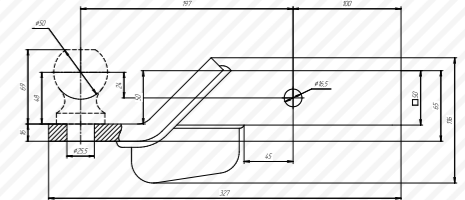

4" – 100 mm

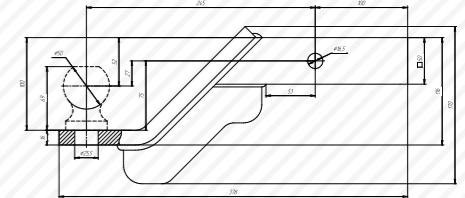

8" – 205 mm

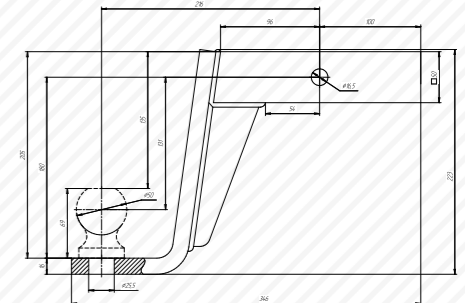

HITCH ADAPTERS



The hitch adapter (removable hitch) is required to connect a low trailer to a lifted 4x4 vehicle, since it allows horizontal alignment of the drawbar. The RIF hitch is made of a steel square tube with 5 mm walls and is compatible with the standard 2" (5 cm) hitch receiver. There is a hole for the locking pin.

The adapter may be removed while offroad driving if necessary.

Available in big, small and medium variants



HITCHES FOR FACTORY BARS

For the standard vehicles  offers reinforced hitches for factory front and rear bars.

Heavy-duty hitch with a thick-wall metal 2" receiver, manufactured using high-quality welding procedures, is intended for high loads.

The hitch is attached to the frame of the vehicle under the factory bumper bar and is almost entirely hidden when the towing piece is removed.

The front hitch makes it possible to use various helpful accessories, e.g. a sill for engine maintenance or a powerful portable winch with a capacity of up to 4.3 tons. You can also use the front hitch while parking a trailer, which is especially convenient if the trailer is large.

 hitches have an impressive margin of safety and is suitable for extreme conditions.

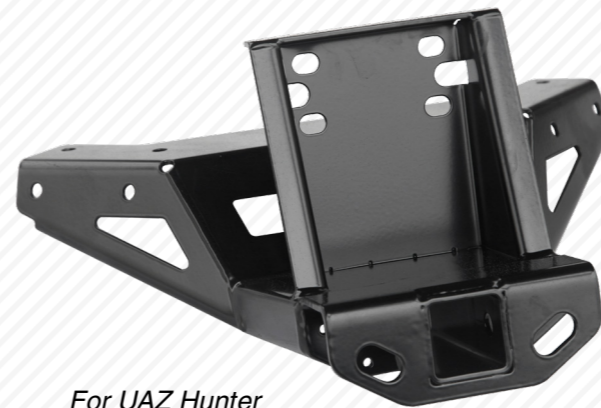

For UAZ Hunter



Front hitch on UAZ Patriot

REMOVABLE BAR FOR HI-JACKING

Using this compact bar you may hi-jack your standard UAZ! All you need - is RIF front or rear hitch for factory bar!



For UAZ Bus



STEEL OFF-ROAD WHEELS FOR UAZ



5X139,7; 7", 8", 10", 12"; R15, 16, 17; D110

High quality steel Off-Road Wheels were designed especially for harsh offroad conditions. Durable powder coating protects the wheels from chips and scratches, preventing corrosion. Wheels are available in three variants: chrome, white and black. It is recommended to use hub caps, which are offered in the same range of colors.

Steel wheels is resistant to damage, they won't crack after hitting against the stone, may be will receive only a dent, which is easy to repair with the help of a hammer. Steel Off-Road Wheels are easy to balance. In addition, thanks to an accurate welded seam and high-quality powder coating, their attractive appearance will be really long lasting!



BEADLOCK AND SIMULATED BEADLOCK WHEELS



For a vehicle with beadlock wheels it is not recommended to drive on open roads because of the possibility of self-unscrewing bolts. In situations where tire pressure is insufficient to hold the bead of the tire in place, a beadlock is needed – it will prevent a bead of the tire to come off the rim completely. Beadlock will surely secure the bead of a tire to the wheel of a vehicle.

Pseudo beadlock wheels have brutal beautiful appearance – but these are just common steel wheels for those, who do not drive offroad, but love the look of beadlock wheels!



ALLOY WHEELS



Alloy wheels are designed primarily for urban driving and light off-road, where the probability of damaging the wheel is small. The design of alloy wheels corresponds to the image of UAZ 4x4 – it is brutal, but at the same time exquisitely beautiful and modern. In addition, they have very little weight, which has a favorable effect on driving comfort, handling and dynamics of the vehicle, and thanks to which they are perfectly balanced!





FENDER FLARES



5 CM
AND 8.5 CM

If the track of your 4x4 vehicle has been widened by the installation of wider wheels and tires, wheel spacers or disks with a negative offset, then the wheels will go out of the wheel arches. Thus, splashes of water, dirt, small stones and gravel will hit the windows and sides of the vehicle. This is impractical and dangerous, since that damages the paint and reduces visibility for both the driver and the passengers. Even during a city drive the vehicle will get dirty after the smallest rainfall.

The versatile fender flares by eliminate the negative consequences of track widening and make your vehicle look more elegant. RIF fender flares are known for their high quality and precision, they can be used with any 4x4 vehicle, and their attractive price makes them steps offer a very strong and durable design, having been engineered for tough conditions. They are made of

one-piece steel pipe with no welding seams. The steps are secured to the frame of the vehicle using U-bolts. Suitable for hi-jacking.

Affordable for everyone. The versatile fender flares can be easily fixed to wheel arches of any length using self-tapping screws and galvanized backplates.

Established brands by foreign manufacturers use PVC to make their fender flares, which limits their usefulness in the Russian climate.

fender flares are made of the most advanced TR material, which remains elastic in a wide range of temperatures – from -55 °C to +135 °C. The material is very durable and flexible, it is resistant to UV, ozone, oil and petroleum products, and it can withstand bending action.

In the kit: fender flare (length 6 m), backplates (32 pcs.), self-tapping screws (64 pcs.)

SELF-LOCKING WORM-GEAR DIFFERENTIAL

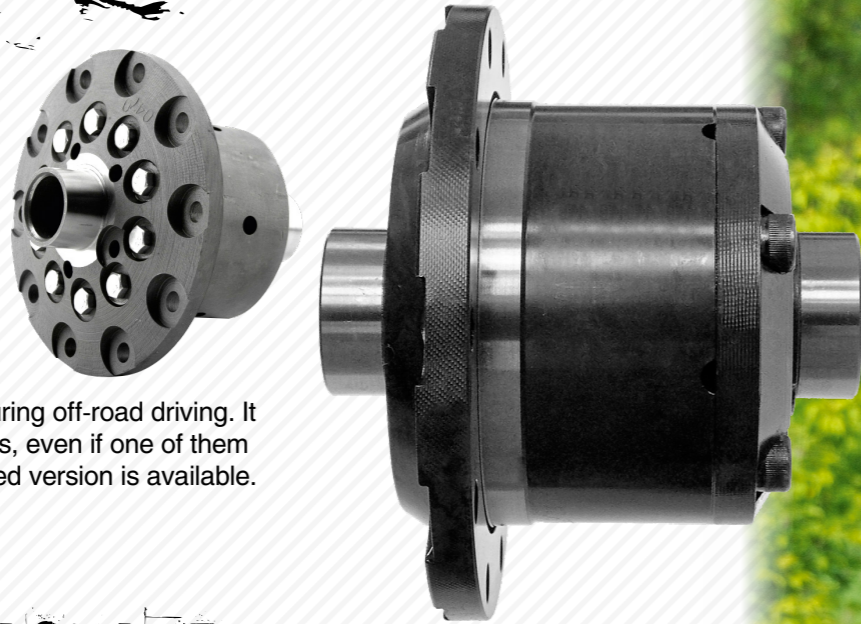

The locker is truly necessary for any 4x4 during off-road driving. It allows sending engine torque to both wheels, even if one of them is in the air. 80% blocking factor. A preloaded version is available. Manufactured from 40X steel.

GEAR CHANGE PACKAGE

Regear your UAZ with top quality gears – this will give huge improvements in both performance and economy by properly matching vehicle's gear ratio to its tire size all while reducing strain on the vehicles drivetrain. Like in average daily driving, lower gears will also perform perfectly on hardcore off-roading, as the smaller minimum speed of driving will let move slowly and accurately in difficult road conditions.





www.rif4x4.ru

Russia, Moscow, Volokolamskoye sh. 15/22

Tel.: +7 (495) 981-84-28

+7 (901) 546-39-48

Email: sales@rif4x4.ru